



Regular BOE Meeting

September, 11
2025-26

Report on Mountain View and Lake View Campuses:



| | Lake View Campus | Mountain View Campus |
|--|------------------|----------------------|
| Square Footage | 77,257 sq ft. | 95,961 sq ft |
| Full size classrooms | 23 | 34 |
| Half-classrooms/ offices | 12 | 10 |
| Quarter classrooms/small offices | 3 | 7 |

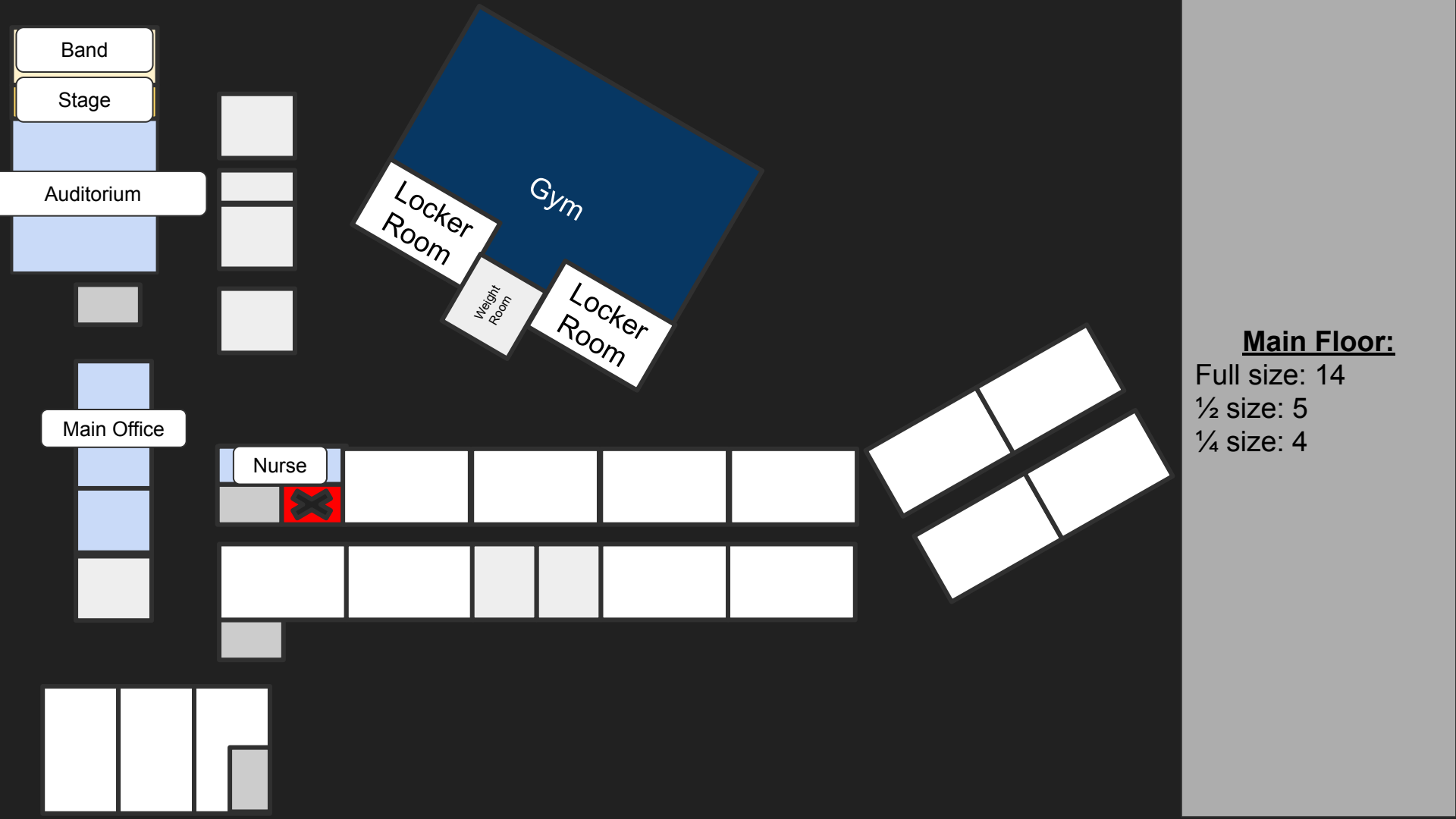

Main Floor:

Full size: 14

1/2 size: 5

1/4 size: 4

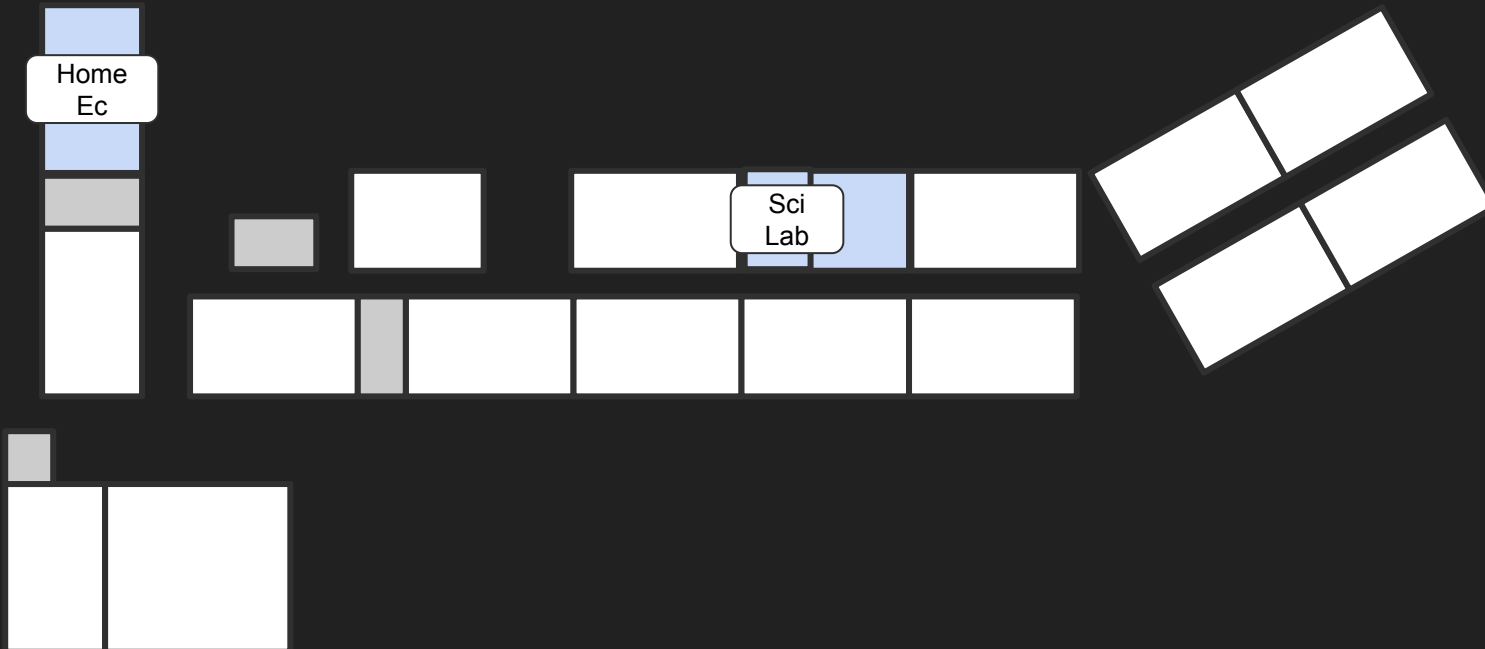

Second Floor:

Full size: 17

1/2 size: 3

1/4 size: 1

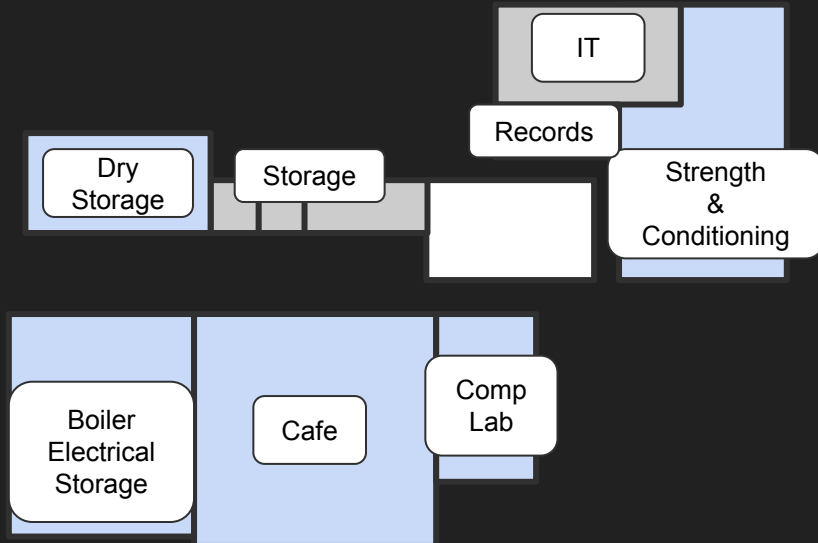

Basement:

Full size: 3

1/2 size: 2

1/4 size: 2

2025-26 Space Requirements

| | PreK-5 | 6-12 | District Office |
|-----------------|---|---|---|
| Full Classrooms | 23 (PreK-5 x2= 12) (Special Ed/AIS= 8) (OT/PT/Speech= 4) (Social Workers=2) | 21 (6th grade=2) (Math, Sci, SS, Eng=13) (Special Ed= 4) (LOTE=2) | |
| ½ Classrooms | 12 | 8 | 2 (CSE Director, Business Office) |
| ¼ Classrooms | 3 | 4 | 5 (CSE Clerical, Superintendent, Clerical x2, Grants) |
| Storage | =~1-1.5 classrooms | =~1-1.5 classrooms | |

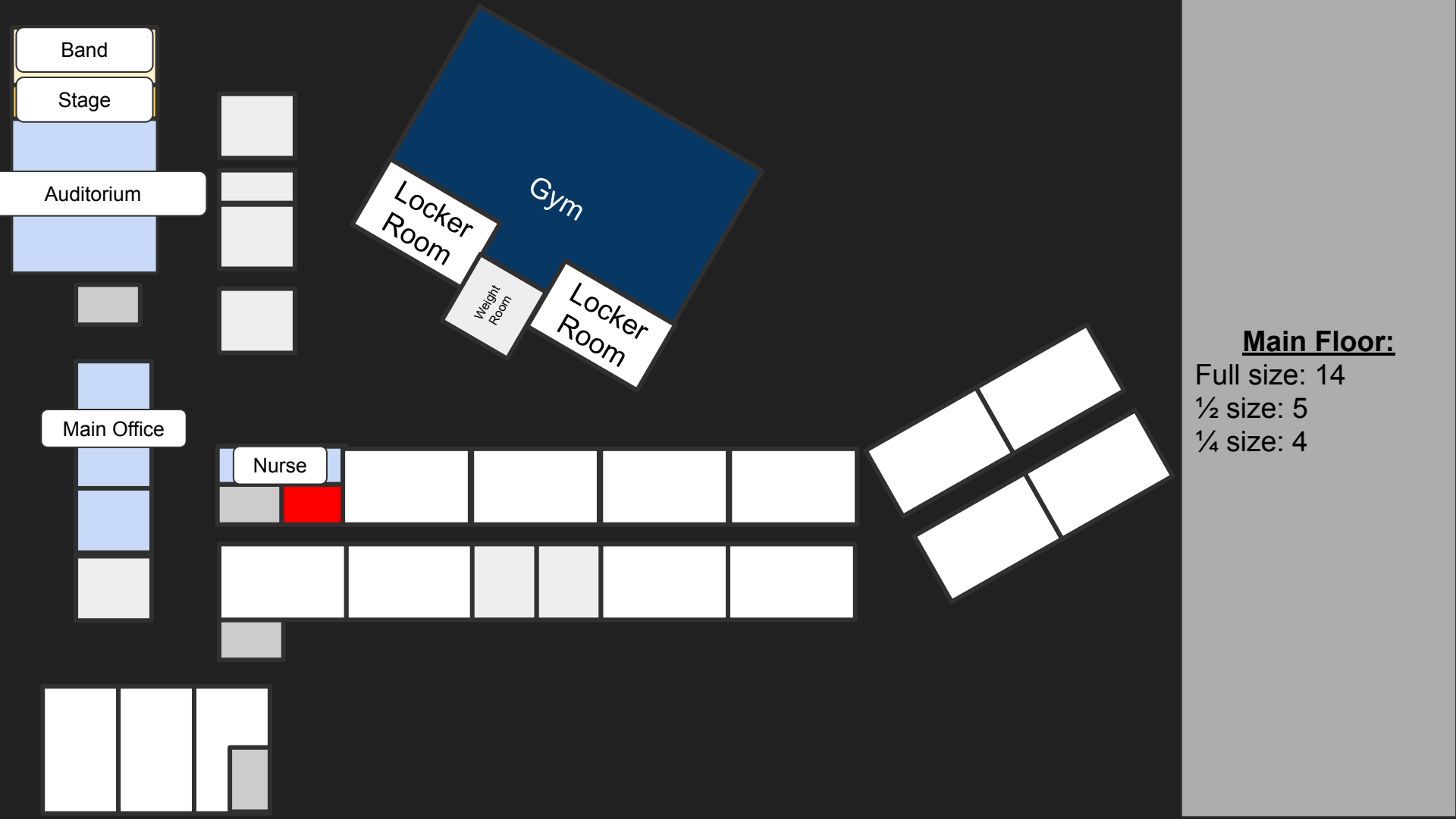

Main Floor:

Full size: 14

1/2 size: 5

1/4 size: 4

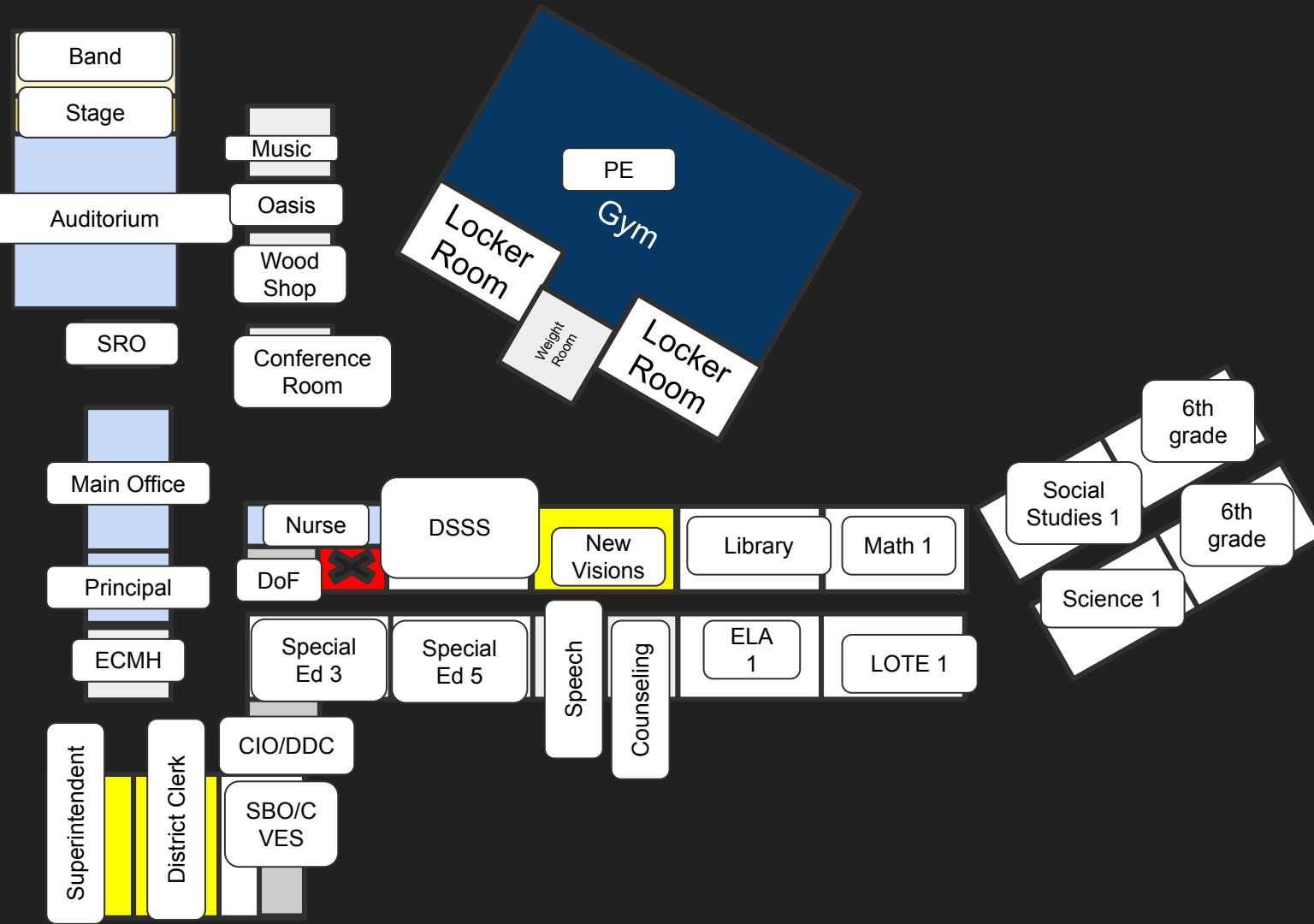

Main Floor:

Full size: 14
 1/2 size: 5
 1/4 size: 4

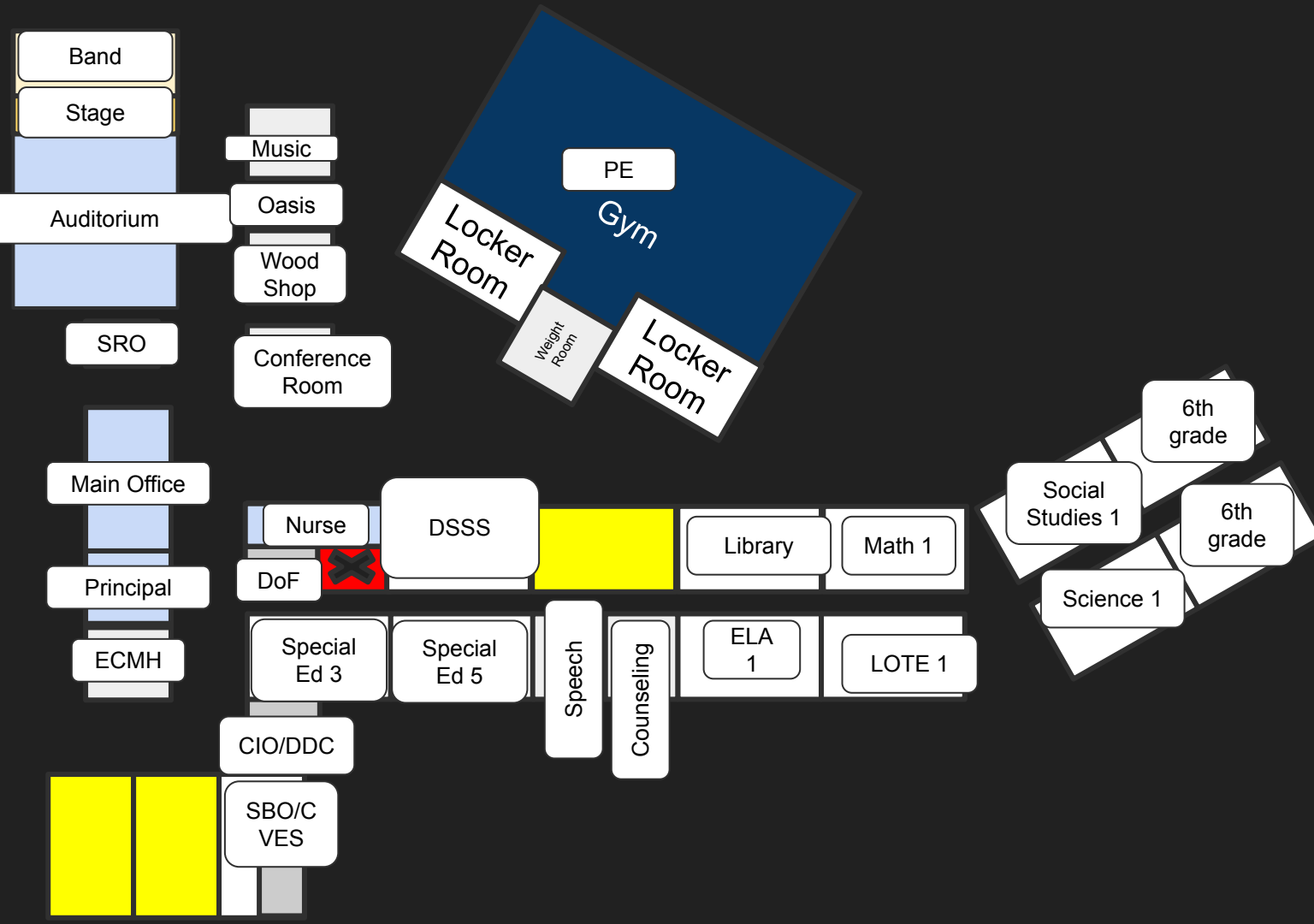

Main Floor:

Full size: 14
 1/2 size: 5
 1/4 size: 4

Displaced

Superintendent

District Clerk

New Visions

Main Floor:

Full size: 14

½ size: 5

¼ size: 4

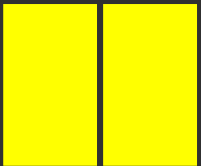

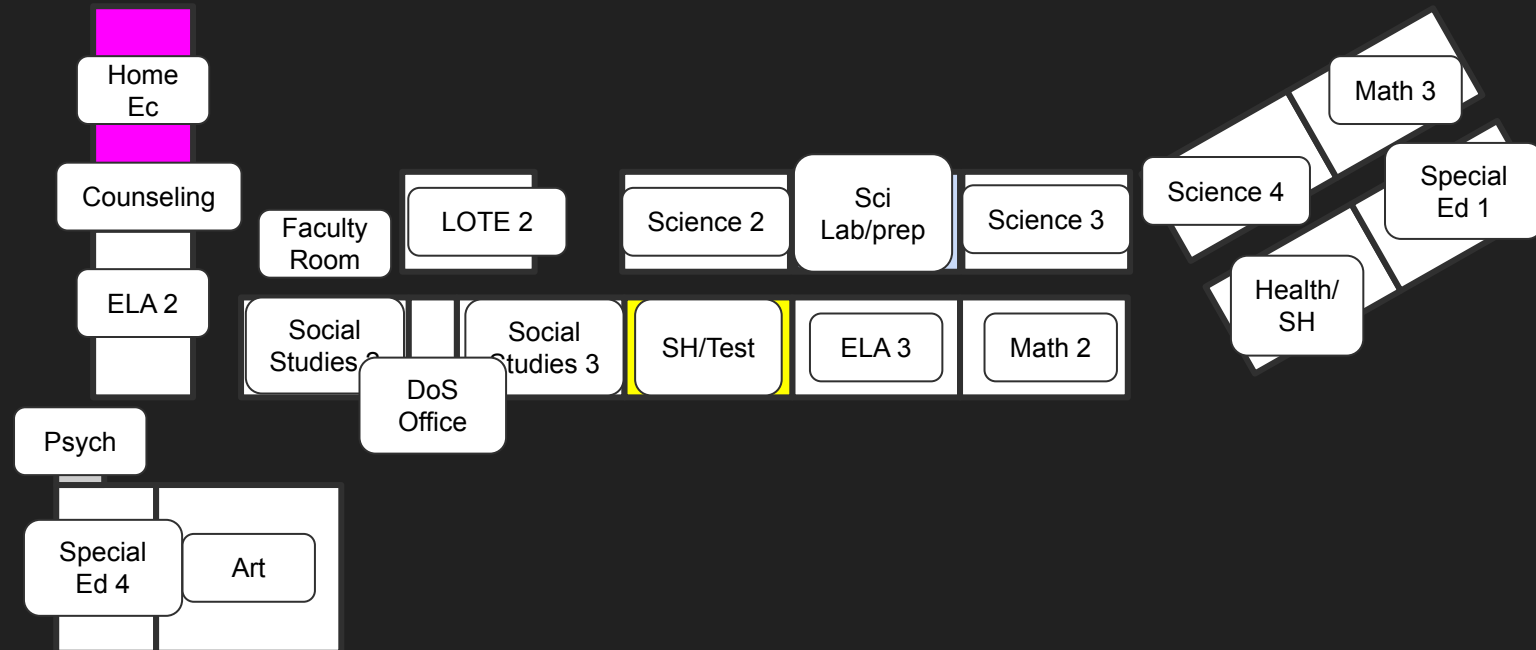

Second Floor:

Full size: 17

1/2 size: 3

1/4 size: 1



Second Floor:

Full size: 17

½ size: 3

¼ size: 1

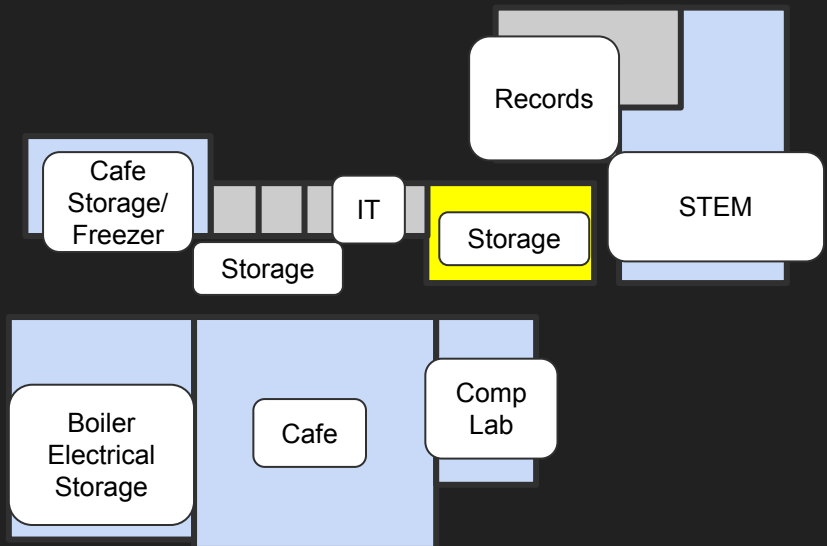

Basement:

Full size: 3

1/2 size: 2

1/4 size: 2



Basement:

Full size: 3

1/2 size: 2

1/4 size: 2

Displaced

Superintendent

District Clerk

New Visions

B

1

2

1

1

**Total Available
Space:**

Report on Mountain View and Lake View Campuses:



| | Lake View Campus | Mountain View Campus |
|--------------------------------------|------------------|----------------------|
| Square Footage | 77,257 sq ft. | 95,961 sq ft |
| Full size classrooms | 23 | 34 |
| Half-classrooms/ offices | 12 | 10 |
| Quarter classrooms/ small offices | 3 | 7 |



Business Office Update

Summer Accomplishments

- Annual External Audit
 - Completed 2 weeks earlier than last year. Auditors to present their findings at the October or November meeting depending on their availability
 - No findings in testing of payroll and purchasing
- Payroll and Attendance Rollover
 - System Revamp - Ease of use for next year rollover
- 450 Purchase Orders Processed
- Closed 2024-2025 Fiscal Year
- Completed New Employee Onboarding Website
- Completed State Aid Review
 - No Findings
- School Taxes
 - Calculated Tax Rates and Issued Tax Bills
- All FS-10F Reports Completed
 - ESD/SVP (OASIS), Titles, IDEA, UPK

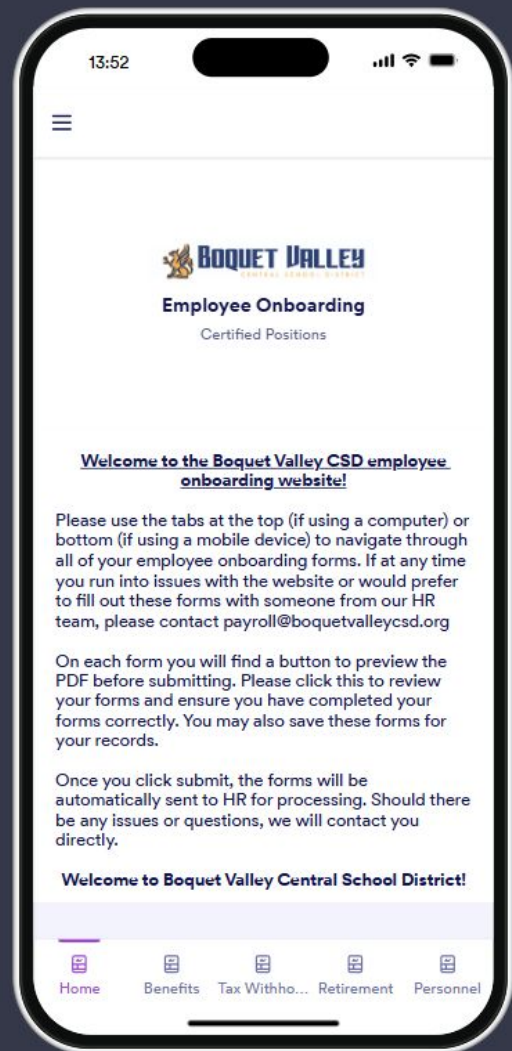



What's coming up?

- ST-3 Season
 - Annual State Aid “Application”
 - Drives all general fund aid
- STAR Reimbursement Application
 - Due October 1 for payments in January
- STAC Applications and Verifications
 - Drives our high cost / excess cost aid
- 2026-2027 Budget Calendar
 - Draft calendar to be presented at a future BOE meeting
- New Payroll Specialist
 - Begins September 29th



Financial Updates

- ERS Employer Contribution Increase to 16.5% from 15.2%
- TRS Employer Contribution Remains at 9.59%
- State Projecting a \$34 Billion Deficit between now and 2029
- BOCES Aidable Salary Cap Increased
- Governor's Budget Expected Around January 15th

Superintendent Report



- Grants Update
- Capital Project Update
- Facilities Update
- Air Quality Report
- Enrollment Report
- Portrait of a Graduate
- Monthly Snapshot Reports

Grants Update



- UPK grant submitted, pending approval
- ESSA funding, submitted and pending approval
- IDEA 611 / 619 Completed
- ESD Final report for year 4 will be submitted Monday, September 15
- Year 5 school year programming is underway with exciting opportunities, including: Photography, drama, baking, mountain biking, walking, lego stop motion, and more!

Capital Project/EPC Update



Capital Project

Proposals have been received for both geotechnical investigations and a site survey at the Mountain View campus. The proposals have been reviewed by the architect, who recommends awarding the following services:

- **Geotechnical Investigations:** Soil Borings throughout the site to assess subsurface conditions within the footprint of the proposed building addition. This work is required for foundation design.
 - Atlantic Testing Laboratories (ATL)
- **Site Survey:** A topographical survey of the Mountain View campus to document existing grades, utilities, and other site related information needed for the design of the proposed building addition, athletic field relocation, and entrance loop.
 - AES Northeast

Energy Performance Contract

Project in NYSED Review Process, awaiting a vote date

Facilities Updates

Mountain View Campus:



Air Quality Report



Overall Results

- ATL reports this round showed “good improvement” over previous testing
- Most readings were very good; no health or safety concerns identified

Key Points from ATL Conversation (8/18/25)

- Crawl space mold is expected and cannot be eliminated
- Annual monitoring is more than sufficient
- Boquet Valley monitors air quality more frequently than most districts

Comparing Campuses

- Mountain View had more rooms with elevated readings
- No evidence either campus is more or less safe than the other

Notable Improvements

- VOC levels decreased
- Fewer CO₂ exceedances, especially at Lake View

Ongoing Concerns

- Air movement remains the biggest issue at both campuses
- Full ventilation overhaul would be ideal but cost-prohibitive

Recommended Actions

- Continue annual testing
- Use fans, open windows and doors when possible
- Consider long-term ventilation improvements during capital planning

Enrollment Report

2025-26



| | |
|-------------------------|------------|
| 14 - OOD placement | 0 |
| 12 - Class of 2025-2026 | 37 |
| 11- Class of 2026-2027 | 24 |
| 10 - Class of 2027-2028 | 29 |
| 9 - Class of 2028-2029 | 29 |
| 8 - Class of 2029-2030 | 39 |
| 7 - Class of 2030-2031 | 34 |
| 6 - Class of 2031-2032 | 25 |
| 5 - Class of 2032-2033 | 29 |
| 4 - Class of 2033-2034 | 31 |
| 3 - Class of 2034-2035 | 25 |
| 2 - Class of 2035-2036 | 32 |
| 1 - Class of 2036-2037 | 23 |
| K - Class of 2037-2038 | 23 |
| PK | 26 |
| PS | 1 |
| Total | 407 |
| 2024-25 Total | 401 |

Monthly Snapshot Reports



- Monthly Spreadsheet: (October-July)
 - Principals
 - Nurses
 - Athletic Coordinator
 - Cafeteria
 - Counselors
 - Director of Student Support Services
 - Director of Facilities and Transportation
- Monthly Superintendent's Update/Presentation
- Monthly Administrator Update/Presentation
- Weekly Updates from Superintendent

Overview of the Portrait of a Graduate



Purpose:

- NYSED is shifting diploma requirements and instructional priorities to better prepare students for college, career, and civic life.
- Portrait of a Graduate and CR-S are key pillars in this work.
- This is not an "add-on" but a lens through which to view our teaching and relationships.

Key Points:

A New York State graduate is:

- **Academically Prepared**
- **A Creative Innovator**
- **A Critical Thinker**
- **An Effective Communicator**
- **A Global Citizen**
- **Reflective and Future-Focused**
(Source: NYSED, July 2025)





New York State
PORTRAIT OF A GRADUATE



A New York State high school graduate who is **culturally responsive** builds strong, respectful relationships, valuing diverse perspectives as essential to a rigorous, inclusive learning community. New York State students who embody cultural responsiveness and academic readiness—demonstrating creativity, critical thinking, communication, reflection, and global awareness—will be prepared to learn, grow, innovate, and contribute meaningfully to society. These graduates will be equipped with the interpersonal and intellectual skills needed to thrive in an interconnected, ever-evolving world.



Academically Prepared

Demonstrates a strong foundation in the NYS learning standards and is equipped with the knowledge and skills necessary to achieve success in college, careers, civic engagement, service, and life.



Creative Innovator

Utilizes imagination, curiosity, and flexible thinking to solve problems creatively, and develop new ideas and products, while adapting to evolving circumstances and challenges.



Critical Thinker

Analyzes information thoughtfully, evaluates evidence critically, and identifies patterns and connections between different pieces of information (across multiple content areas) to address complex issues and navigate the world with insight.



Effective Communicator

Articulates ideas clearly and confidently through speaking, writing, and the use of different types of media for various purposes, while engaging with diverse audiences and actively listening to different perspectives.



Global Citizen

Acts responsibly and ethically within local, global, and digital communities, employing civic knowledge, skills, and mindsets to promote global sustainability and contribute positively to a culturally diverse, democratic society.



Reflective and Future Focused

Engages in self-reflection to identify strengths and areas for growth, sets meaningful goals, uses social awareness to maintain supportive relationships, and demonstrates responsible decision-making that prioritizes social, emotional, and mental well-being.



Academically Prepared

Demonstrates a strong foundation in the NYS learning standards and is equipped with the knowledge and skills necessary to achieve success in college, careers, civic engagement, service, and life.



Creative Innovator

Utilizes imagination, curiosity, and flexible thinking to solve problems creatively, and develop new ideas and products, while adapting to evolving circumstances and challenges.



Critical Thinker

Analyzes information thoughtfully, evaluates evidence critically, and identifies patterns and connections between different pieces of information (across multiple content areas) to address complex issues and navigate the world with insight.



Effective Communicator

Articulates ideas clearly and confidently through speaking, writing, and the use of different types of media for various purposes, while engaging with diverse audiences and actively listening to different perspectives.



Global Citizen

Acts responsibly and ethically within local, global, and digital communities, employing civic knowledge, skills, and mindsets to promote global sustainability and contribute positively to a culturally diverse, democratic society.



Reflective and Future Focused

Engages in self-reflection to identify strengths and areas for growth, sets meaningful goals, uses social awareness to maintain supportive relationships, and demonstrates responsible decision-making that prioritizes social, emotional, and mental well-being.

Overview of the Portrait of a Graduate



Key Points:

- Graduates are expected to learn, grow, create, work, and contribute.
- The PoG promotes interdisciplinary, student-centered learning.
- CR-S education is embedded within this model, preparing students for an interconnected world.



Culturally Responsive-Sustaining Education



Key Points:

- CR-S education affirms cultural identities, prepares students for rigorous learning, and empowers them as agents of social change.
- It is grounded in the belief that diversity is an asset, not a deficit.
- The framework is organized around four key principles.

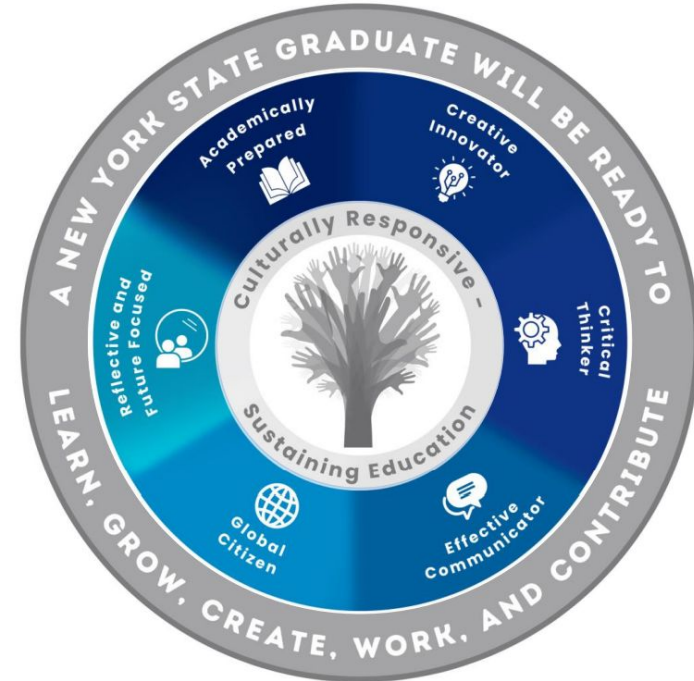

Culturally Responsive-Sustaining Education



Four Key Principles:

- Welcoming and Affirming Environment
- High Expectations and Rigorous Instruction
- Inclusive Curriculum and Assessment
- Ongoing Professional Learning

These principles apply to students, teachers, leaders, families, and community partners.



Where We Go From Here?

- Principals will engage staff throughout the year in building toward shared understanding and classroom practices.
- No one is expected to be an expert right away. We have time and we will grow together.
- These frameworks align with our broader district goals: academic excellence, equity, and community partnership.



Thank you

- Next Meeting
- Any Questions?



